



# ASPIRE

— TO MOVE —



## Locksbrook Road, Bath, BA1

Quirky one bedroom house located on Locksbrook Road, Newbridge. Available from August 2025 and would best suit a single professional or couple.

Locksbrook Road is located in Newbridge and offers excellent access to local amenities on Chelsea Road which is 0.2 miles away. Parking is offered on street and is non-permitted.

- One bedroom house
- Council Tax band A
- Unfurnished
- Available August 2025.
- On-street free parking
- 12 month contract
- Holding deposit - one weeks worth of rent - £229

**£995 Per month**

Floor Plans

GROUND FLOOR  
166 sq.ft. (15.4 sq.m.) approx.

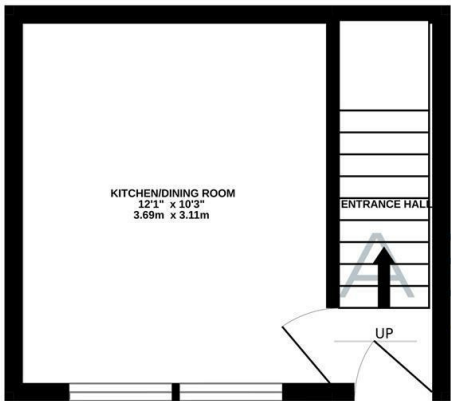

1ST FLOOR  
166 sq.ft. (15.4 sq.m.) approx.

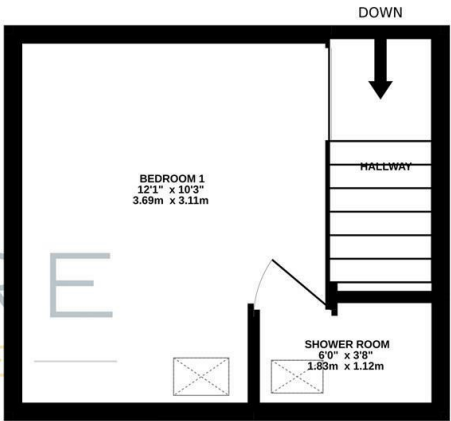

TOTAL FLOOR AREA : 332 sq.ft. (30.9 sq.m.) approx.

Whilst every attempt has been made to ensure the accuracy of the floorplan contained here, measurements of doors, windows, rooms and any other items are approximate and no responsibility is taken for any error, omission or mis-statement. This plan is for illustrative purposes only and should be used as such by any prospective purchaser. The services, systems and appliances shown have not been tested and no guarantee as to their operability or efficiency can be given.

Made with Metropix ©2022

Energy Performance Graph

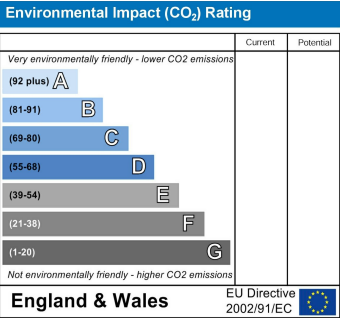
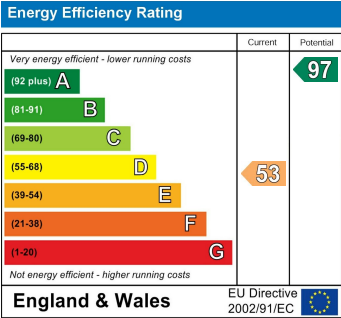

These particulars, whilst believed to be accurate are set out as a general outline only for guidance and do not constitute any part of an offer or contract. Intending purchasers should not rely on them as statements of representation of fact, but must satisfy themselves by inspection or otherwise as to their accuracy. No person in this firms employment has the authority to make or give any representation or warranty in respect of the property.